

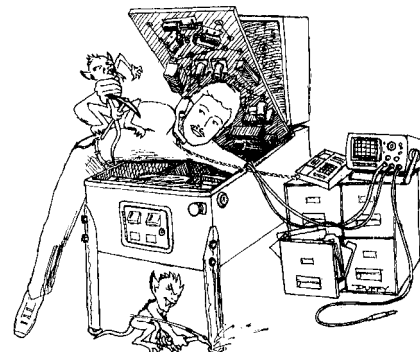

N^o 122 SERVICE BULLETIN



Joe Blackwell Director, Parts Sales & Technical Support	Susan White Parts Sales Manager	Tashia Miles Customer Service Representative	Patty Schrap Parts Stockroom Manager	Jim Thornton Technical Support Engineer	Chas Siddiqi Technical Support Engineer	Jay Alfer Technical Support Doc. Administrator
---	---------------------------------------	--	--	---	---	--

TO: Parts & Service Managers

DATE: February 22, 2001

SUBJ: High Roller Casino Roulette Wheel (Top & Bottom) Assembly



Highlights:

1. The assembly can be disassembled from the top or bottom of the playfield.
2. The clutch action will eliminate ball jams and is used for safety.
3. The Roulette Wheel does not utilize mechanical switches, rather it features a 4-Pos. OPTO PC Board

Explanation:

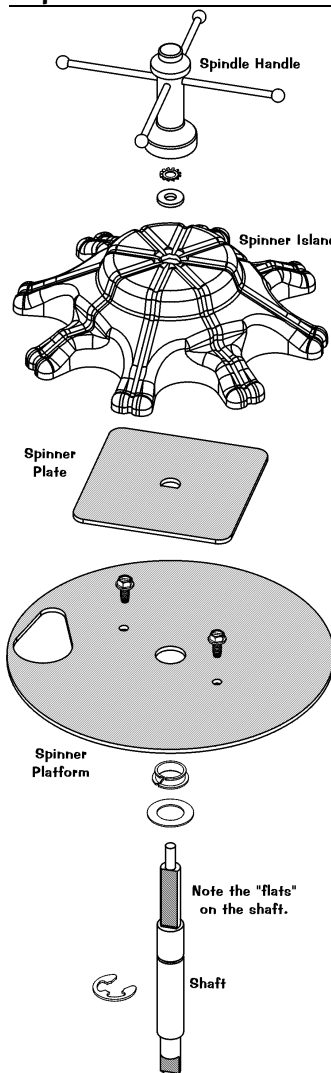

We continually strive to decrease the amount of maintenance required on the playfield by improving the reliability of the mechanical assemblies. We looked at the Roulette Wheel and found a way to prolong the life expectancy of the motor with the addition of a clutch. The motor coupling with Spring Steel Plate* acts as a clutch. There is a flat on the Roulette Wheel Drive Shaft which rests against the Spring Steel Plate*; if a ball jam occurs the Spring Plate will flex allowing the shaft to slip, thus releasing the tension on the motor. The clutch will also relax in the reverse direction once per revolution to help free the ball if a jam occurs within the wheel. The unit is also made with the premise a technician may stick their hands within the moving Roulette Wheel. The Roulette Wheel Assembly, if touched while moving, would spring back away from rotation of the motor to prevent fingers from being caught.

*** Production Note:** The Spring Plate quantity may vary in quantity (1 or 2) from game to game; replace with the quantity used in your game (i.e. If your game has 1, replace with ONLY 1; if your game has 2, replace with ONLY 2). The quantity difference was needed to accommodate gapping differences in the Coupling (Interaupter) Unit.

Manual Addendum (Page 79):

Early games received a Service Game Manual (780-5065-00① Jan 2001) without a corrected page (Page 79). (Note: Manuals produced later included the corrected page). The page corrects the item number order in the Parts Table for the Roulette Wheel Bottom parts (Pg. 79). If the Parts Table starts with **Item 1, Base Plate** your page is correct. For the Parts Table which starts with Item 1, Motor Platform correct as follows: **In the N^o column change the following:** 1 to 8; 2 to 1; 3 to 2; 4 to 3; 5 to 7; 6 to 9; 7 to 6; 8 to 5; and 9 to 4 (10 is 10). The item numbers in referenced in the drawing should match up now. We apologize for this error.

Please *phone* or *eMail* with any questions or comments at the below numbers or address.

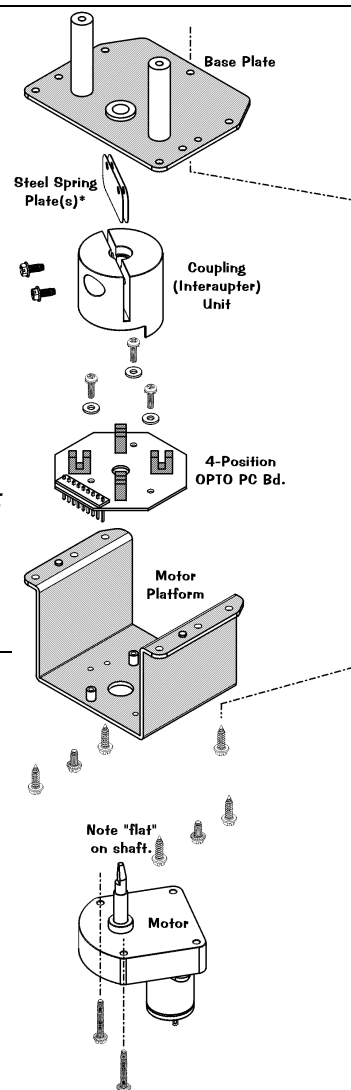

Roulette Wheel Bottom (Motor) Individual Parts Only (Items 1-10) (Works in conjunction with parts on previous pg.)

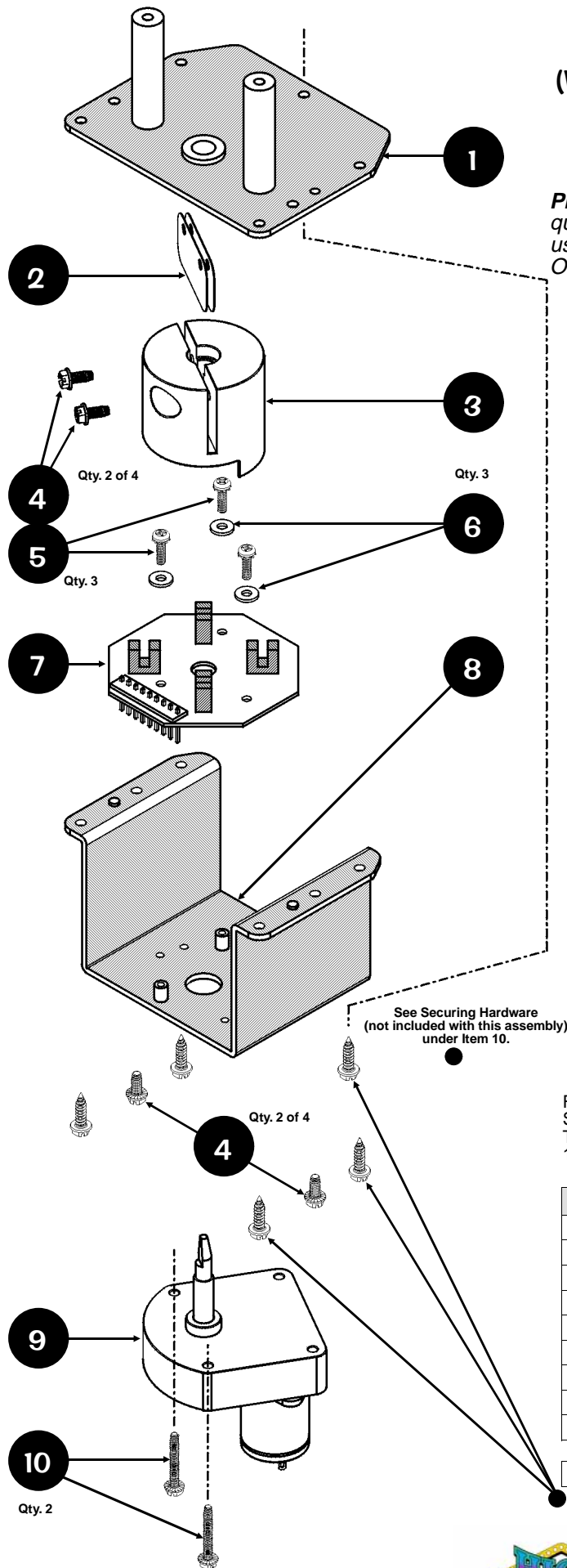

Production Note: Item 2, Spring Plate, may vary in quantity from game to game; replace with the quantity used in your game (e.g. If your game has 1, replace with ONLY 1; if your game has 2, replace with 2).

Take Note:

For a break-down of parts on this OPTO Board (520-5194-01), see Section 5, Chapter 4, 4-Position OPTO PC Board (Roulette Motor) Theory of Operation & Schematic, Component Layout & Parts, Pages 130-131.

Nº	INDIVIDUAL PART NAME	QTY.	SPI PART Nº
1	Base Plate	1	515-7129-00
2	Spring Plate (see Production Note above)	1/2	535-8764-00
3	Coupling / Interrupter	1	530-5570-00
4	#8-32 X 3/8" HWH MS Type C	4	237-5903-00
5	#6-32 X 1/2" PPH (Sems) Zinc	3	232-5202-00
6	#6 Washer	3	242-5001-00
7	4-Position OPTO PC Board	1	520-5194-01
8	Motor Platform	1	515-7130-00
9	Motor & Soldered Cable Wiring Hrns.	1	515-7153-00
10	#6-32 X 1" HWH Slotted Serr Tri-Point	2	237-6050-00

Item 9 Motor Specs: 17RPM 20V DC CCW (Multi) (041-5078-00)

Roulette Wheel Bottom (Motor) is secured under the playfield by: #8 X 5/8" HWH AB (Zinc) Green (Qty.5) (234-5102-04)

